

Micro D-Sub Molded Cable, Right angled

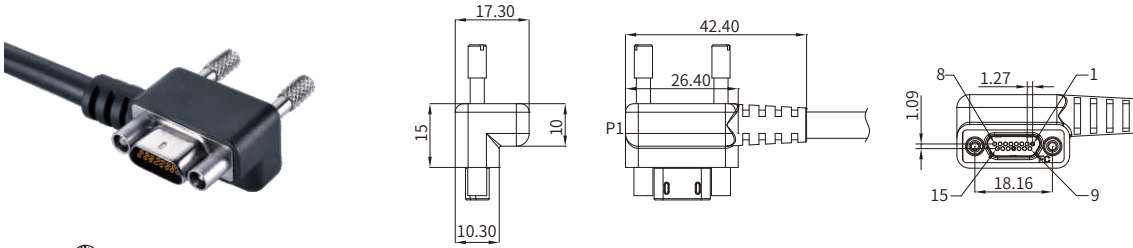

RoHS

Specifications

Contacts	15
Pin layout(Female)	
Ambient temperature	-25°C~+85°C(flexible installation),-40°C~+85°C(fixed installation)
Connector insert	PBT
Connector contacts	Brass gold plated
Coupling nut/screw	Brass nickel plated
Insulation resistance	≥1000MΩ
Contact resistance	≤5mΩ
Shielding	Available
Rated current	1A
Rated voltage	350V AC/DC
Wire gauge	0.08-0.15mm ² (AWG26-28)

Part Number

Pins	Cable length	Female	
		PVC	PUR
15	1m	DBW15FA-10CB15	DBW15FA-10RB15
	3m	DBW15FA-30CB15	DBW15FA-30RB15
	5m	DBW15FA-50CB15	DBW15FA-50RB15

Default wire colors

Pin No.	
Pin 1	BK
Pin 2	BN
Pin 3	RD
Pin 4	OR
Pin 5	YE
Pin 6	GN
Pin 7	BU
Pin 8	VT
Pin 9	GY
Pin 10	WH
Pin 11	PK
Pin 12	LT GN
Pin 13	LT BU
Pin 14	BK/WH
Pin 15	BK/RD
Shell	Braid